

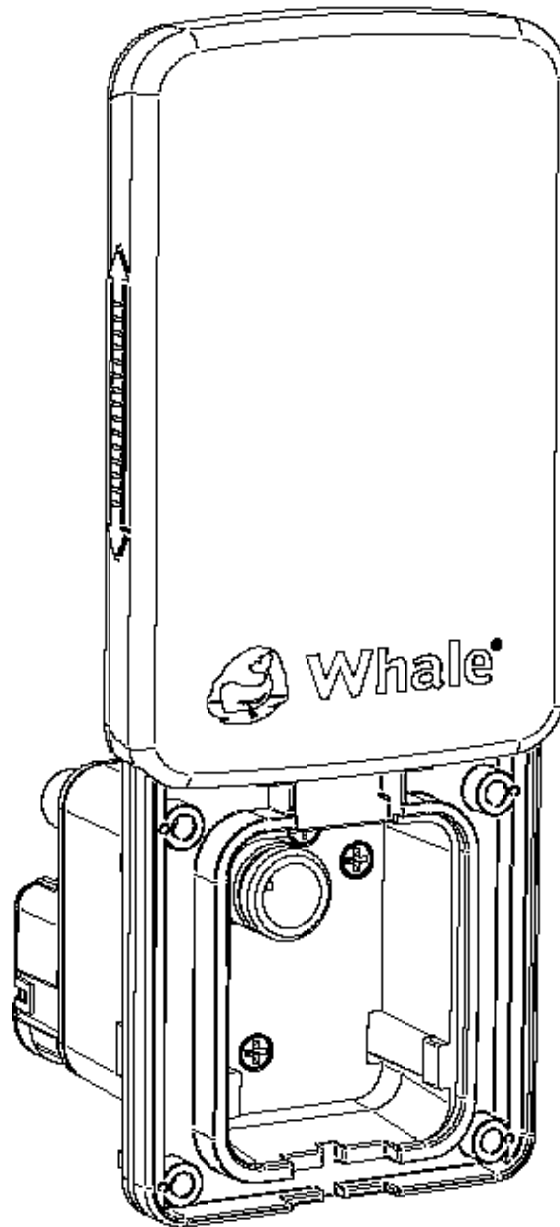

Easi-Slide Exterior Utilities Sockets



Water In Socket

Installation and Operating Instructions

Water In Socket

Installation and Operating Instructions



Water In Socket Pack Contains:

1 x Water In Socket

1 x Screw Kit (retail only)

In addition you will need:

1 x Whale Easi-Slide Lid

Contents:	Page no:
1. Safety	1
2. Water In Socket	2
2.1 Technical Data	2
2.2 Socket Specification	2
3. Before you Begin	3
4. Socket Installation	4-6
5. Fittings Installation	7
6. Operation	7
7. Maintenance / Repairs	8
8. Troubleshooting	8
9. EU Declaration of Conformity	9
10. Socket Mounting Profile	12

1. Safety



- This appliance is **not** intended for use by persons (including children) with reduced physical, sensory or mental capabilities, or lack of experience and knowledge, unless they have been given supervision or instruction concerning use of the appliance by a person responsible for their safety.
- Children **must be** supervised to ensure that they do not play with the appliance.
- Any alteration to the appliance, misuse or use of non-original Whale parts may invalidate the warranty. Non observation of the installation and operating instructions will lead to cancellation of the warranty and exclusion of liability claims.
- For use in recreational vehicles with a typical water system pressurised up to 3 bar.

2. Water In Socket

The Whale Water In Socket is designed for use in recreational vehicles to supply freshwater to the taps and showers. It is the easy way to supply freshwater throughout the vehicle and deliver freshwater to your water heater. This product is designed for use with the Whale Watermaster exterior pump, AquaSmart filter and/or Whale Watermaster mains connector.

2.1 Technical Data

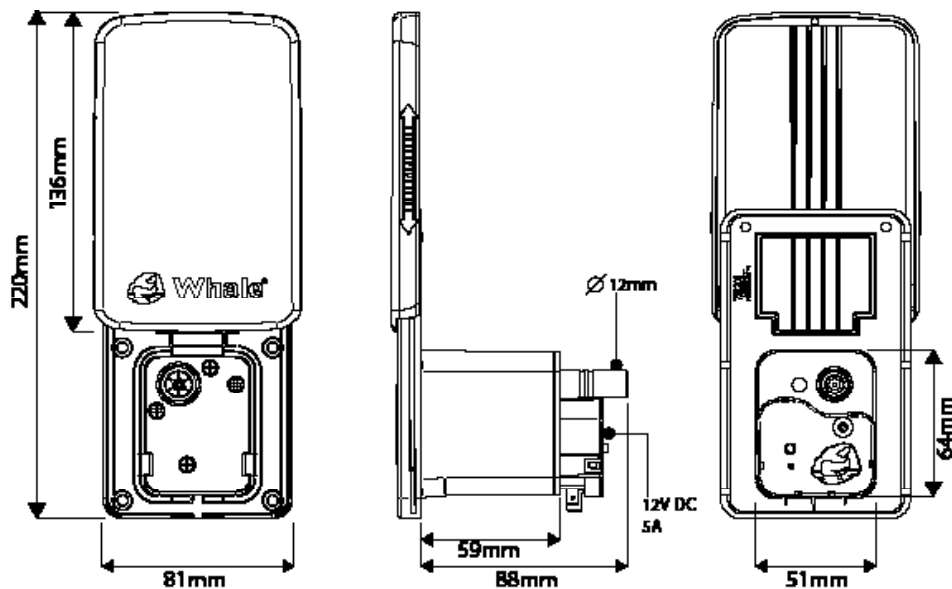

Figure 1. Water In Socket Dimensional Drawings

2.2 Socket Specification

Product Code	Product Description
Sockets compatible with Intelligent Control	
ES8005BR	Whale Water In Easi-Slide Socket with Intelligent Control
Sockets Compatible with Pressure Switch	
ES6001, ES6001B	Whale Water In Easi-Slide Socket with Integrated Pressure Switch
Sockets Compatible with Micro-Switch Taps	
ES6000	Whale Water In Easi-Slide Socket Compatible with Microswitched Taps
Sockets for Filling On Board Tanks in Motorhomes	
ES6002B	Whale Water In Easi-Slide Socket Compatible with Motorhome Autofill
Sockets Compatible with AquaSmart (Onboard Pumps)	
ES6006B	Whale Water In Easi-Slide Socket Compatible with Aquasmart
Socket Lids	
AK1411, AK1412, AK1413	White, Silver & Cream Easi-Slide lids

3. Before You Begin



- Always disconnect power sources before installing or making connections.
- With all applications, it is important that a system of safe working practice is applied to installation, use and maintenance.
- Always ensure water system is drained before commencing any work.

Helpful Hints

- If the cover does not move freely when installed, remove it and ensure guide rails are free from sealant and debris.
- If your socket appears to be twisted when installed, slightly adjust the mounting screws.

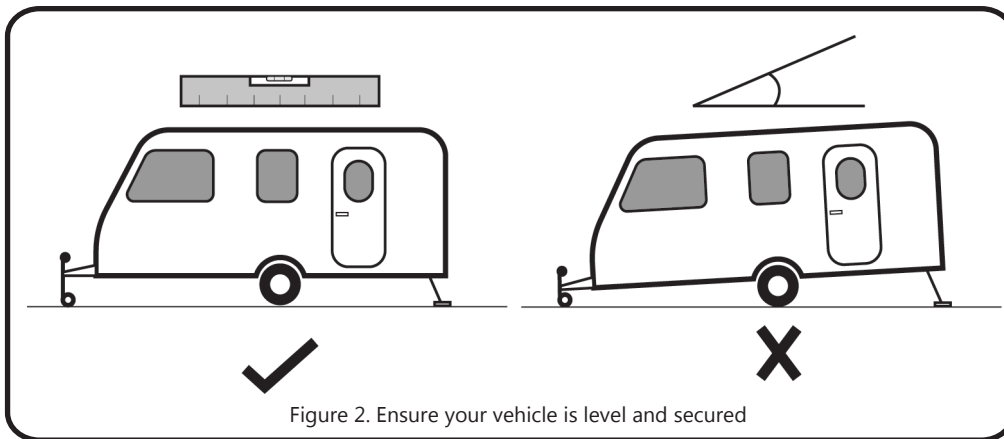

Figure 2. Ensure your vehicle is level and secured

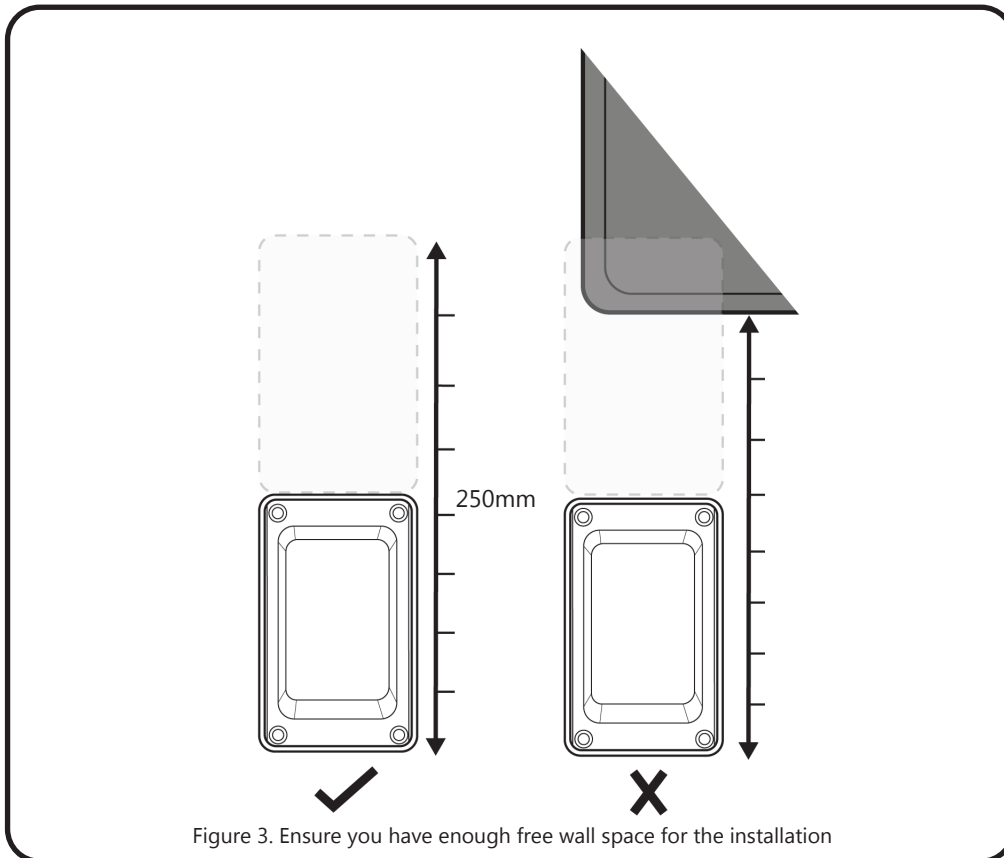
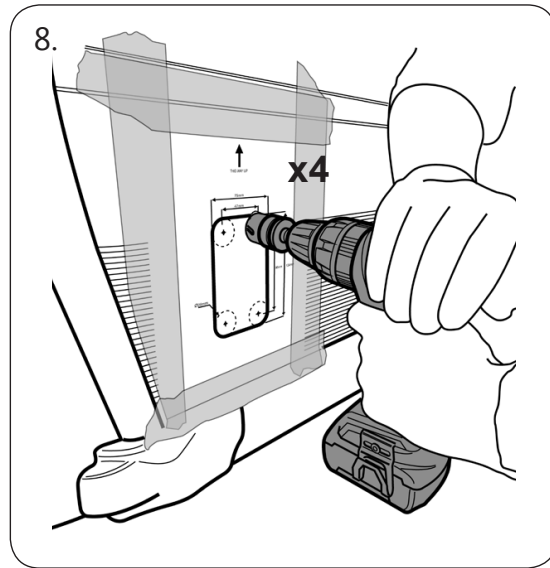
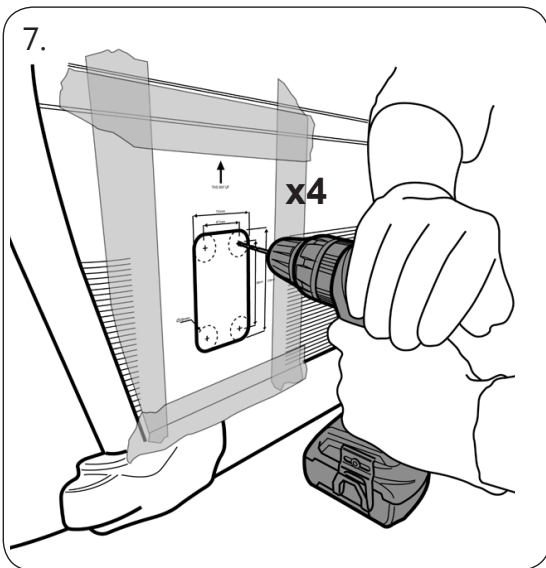
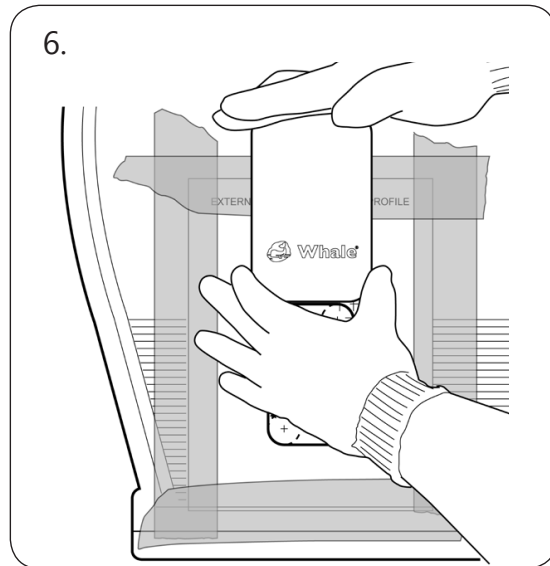
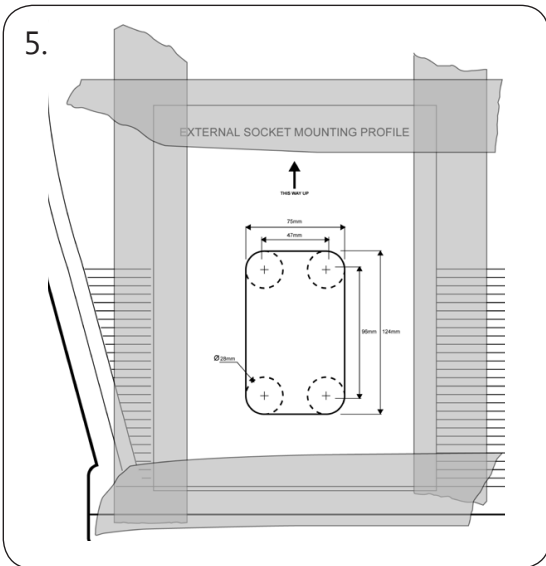
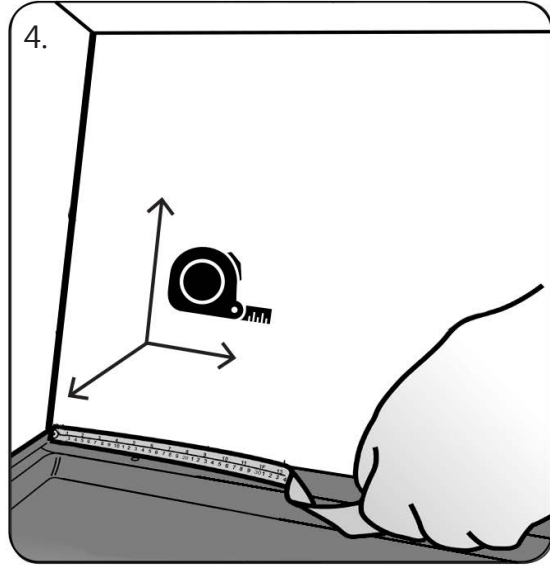
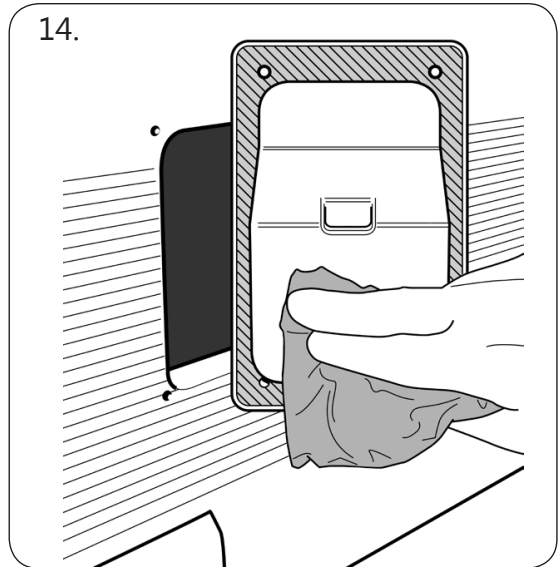
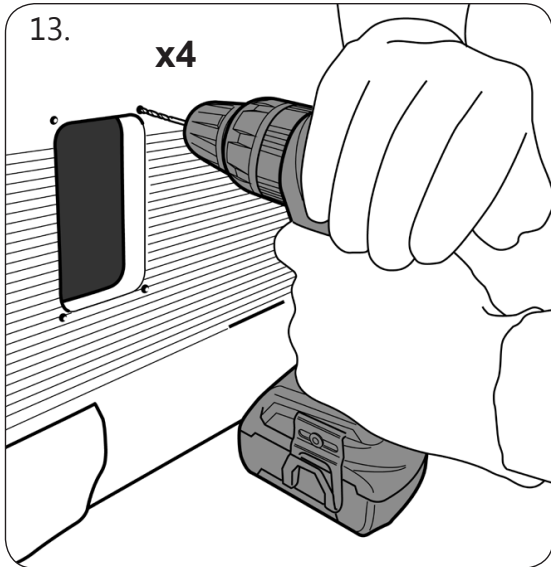
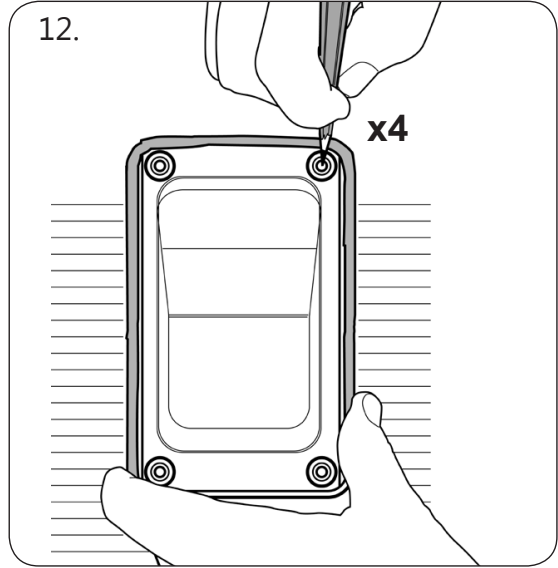
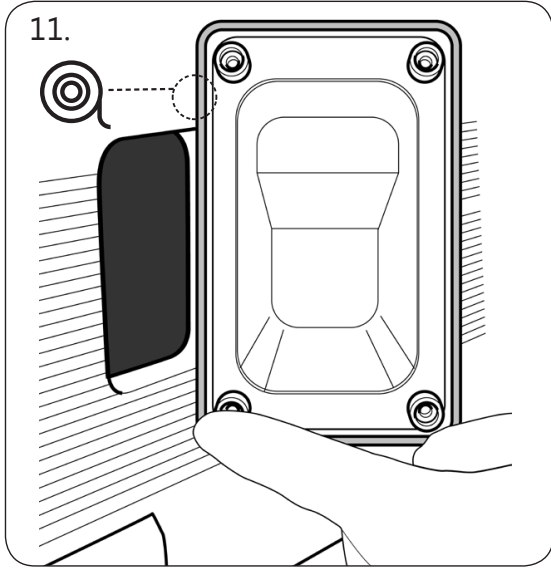
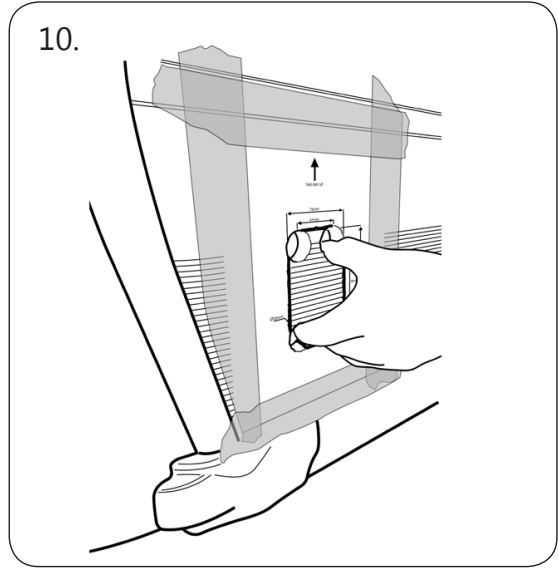
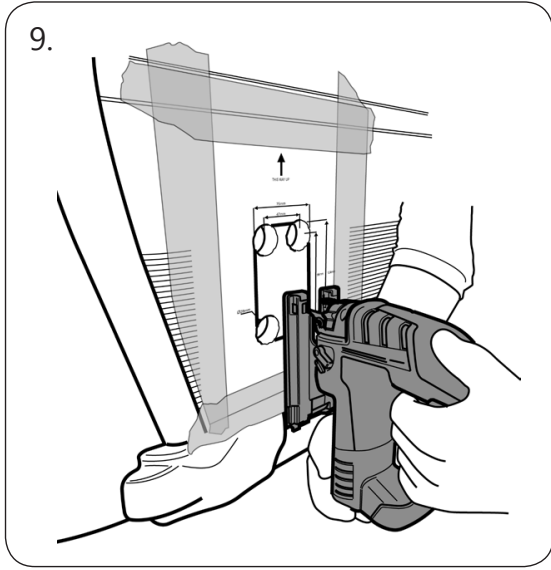
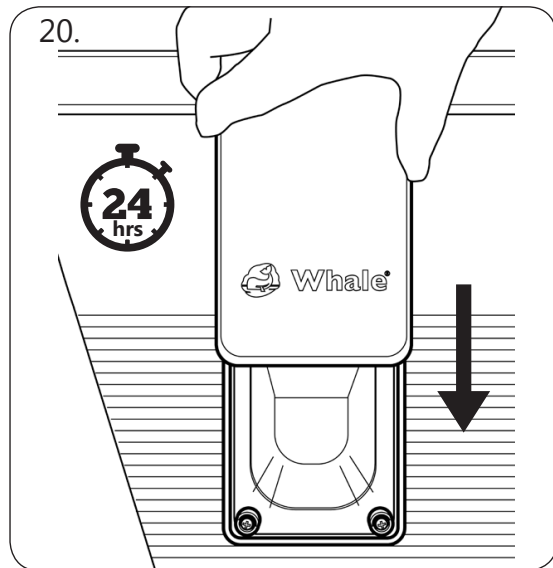
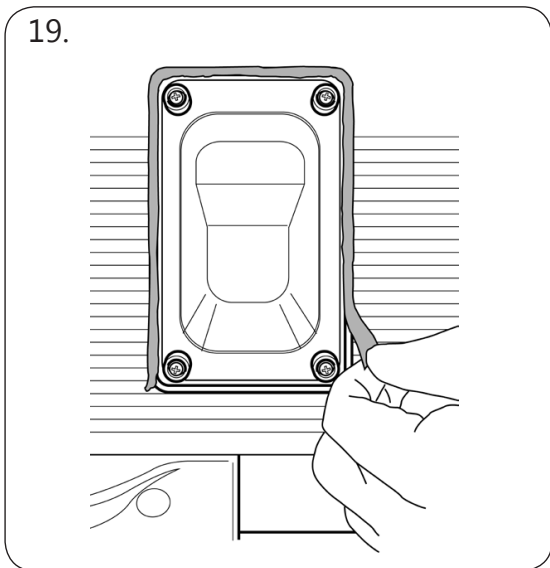
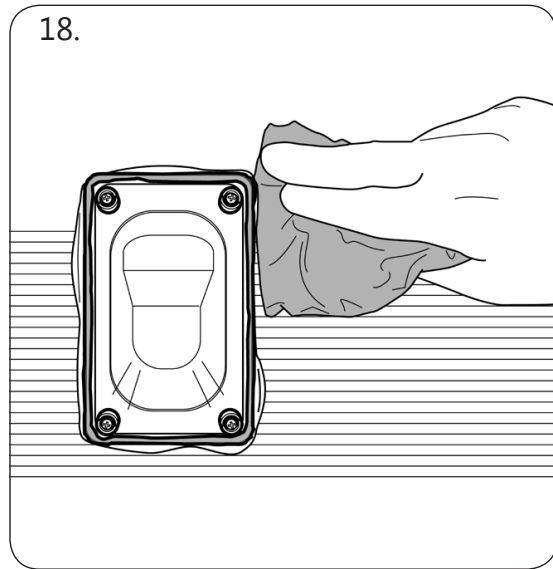
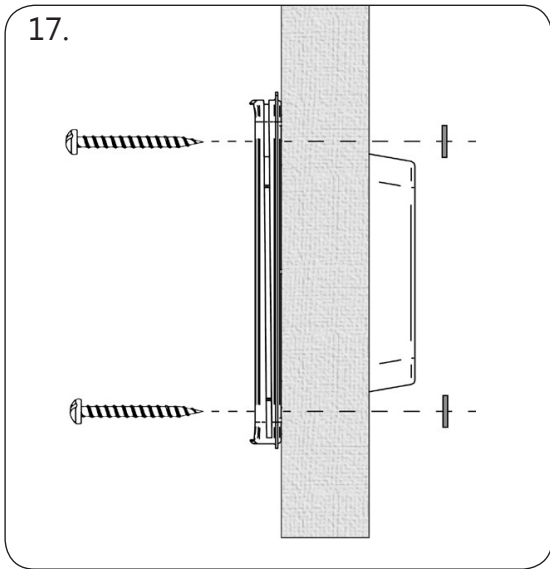
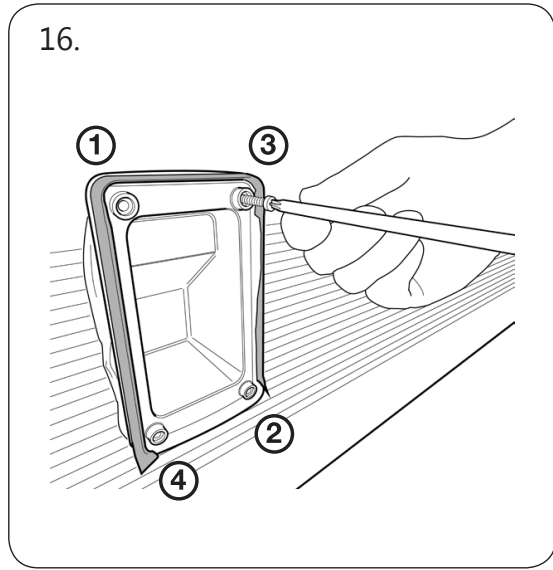
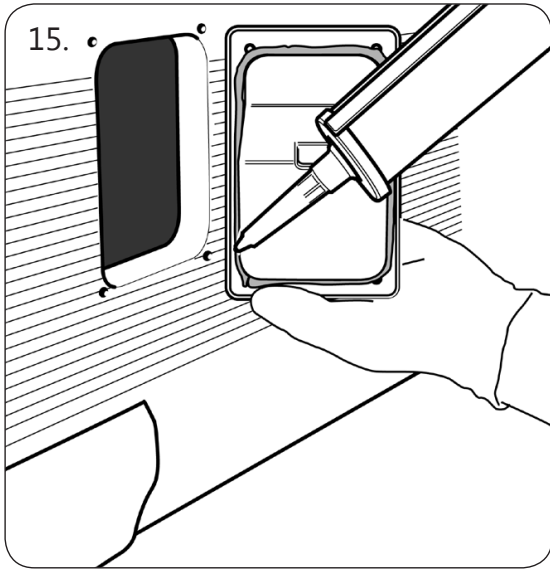

Figure 3. Ensure you have enough free wall space for the installation

4. Socket Installation







5. Fittings Installation

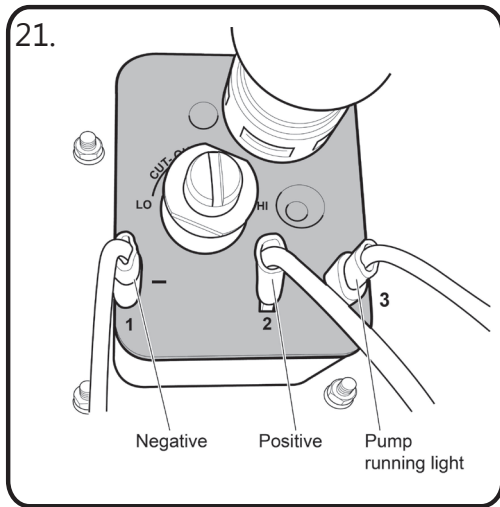

Watermaster Pressure Switched Socket -
Wiring Connections

OR

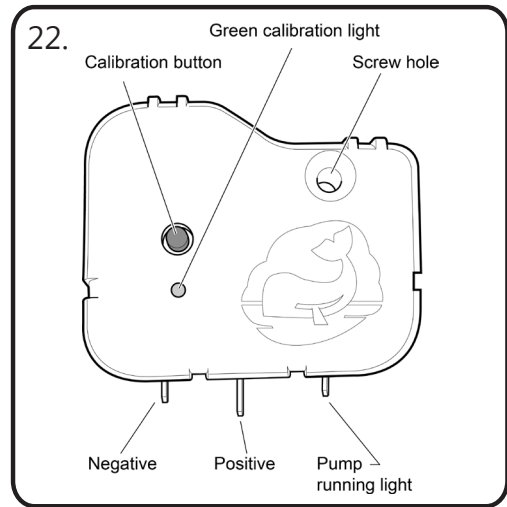

Watermaster IC Socket

Socket	Positive Wire	Negative Wire
ES6001	Tab 2	Tab 1
ES6000	Tab 3	Tab 1

6. Operation

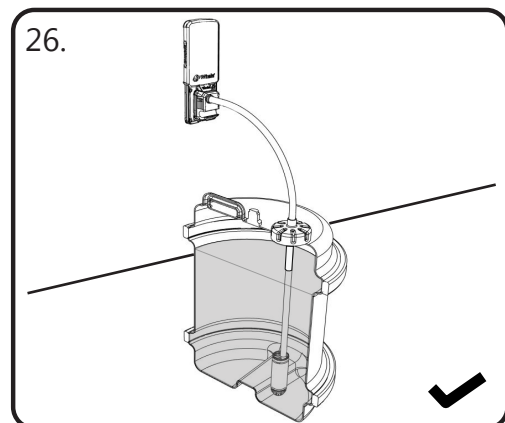
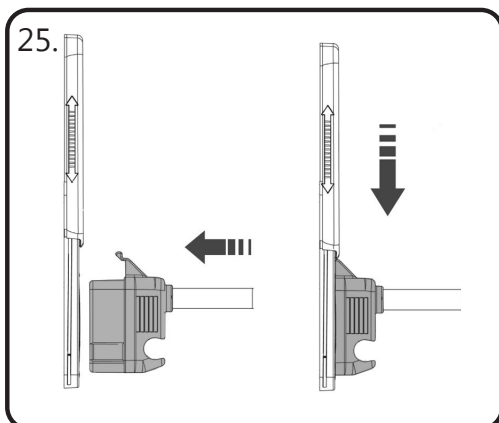
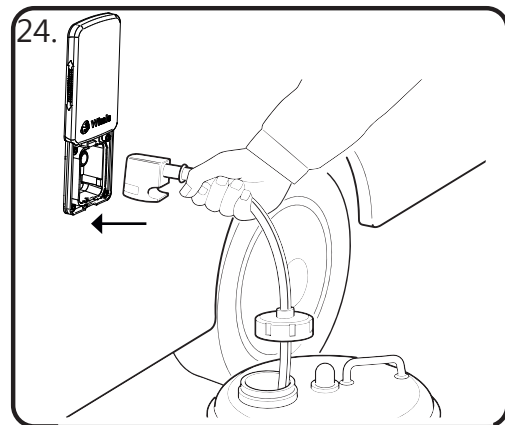
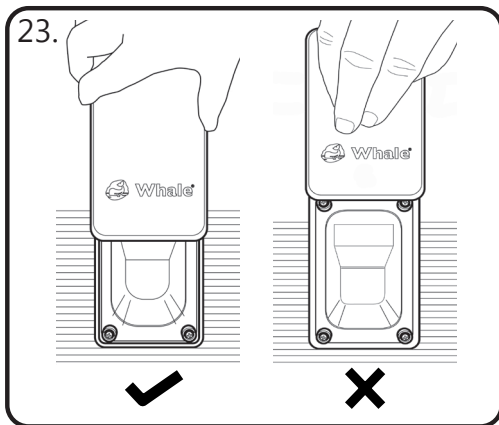

7. Maintenance / Repairs

For installation or serviceable parts advice, please contact Whale® Customer Support.

Whale recommends that you keep the o-rings lubricated for easy and secure connection /removal of the plug to socket. Use a water-based lubricant such as silicone grease.

PLEASE NOTE: DO NOT USE VASELINE OR VEGETABLE OIL TO LUBRICATE O-RINGS.

Helpful Hints

- Make sure the lid clicks over the tab on top of the pump plug to hold it in place.
- Ensure that the power supply is adequate - low performance could result from a weak battery or reduced voltage due to undersized wiring (wiring must be a minimum 1.5mm²).
- Ensure that the pump does not run for more than 15 minutes continuously.
- When replenishing the water supply, an air lock may occur in the pump. As a result, the pump will run noisily and not deliver water. To remedy, unplug from the socket while keeping the pump submerged to dislodge the air pocket in the pump. Shaking the dual hose gently may also dislodge the air pocket in the pump. Alternatively, switch off water pump at master switch, open a tap outlet and switch the pump on again at the master switch.

8. Troubleshooting

Problem	Possible Solution
Pump will not run	Check that at least one tap is open
	Check the battery condition
	Check the mains isolator (master) switch is on
	Check the pump isolator switch is on
	Check the contacts in the plug and socket are clean and making contact
	Check wiring connections
	Check fuse (see fuse box)
	Turn the pump isolator switch off and on again
The pump cycles on/off with all taps and shower closed	Check for air or water leaks in taps and piping
	Check that the non-return valve in socket is free from grit by pushing a suitable blunt object, (e.g. a ballpoint pen) into the socket nipple against the non-return valve holding the valve open to dislodge trapped grit
	Check within 1 year warranty. Contact retailer and replace pump
Runs continuously and does not stop after 30 seconds	Check all connections in pipework

9. EU Declaration of Conformity

Declaration no.: EU-753.133-000

We the undersigned:

Name of manufacturer: Munster Simms Engineering Ltd

Address: 2 Enterprise Road, Bangor, BT19 7TA

Country: Northern Ireland

Declare under our sole responsibility that the following apparatus:

Product description: External water inlet socket

Model name and no.: Water In Easi-Slide Socket

Brand name: Whale®

Is in conformity with the following relevant EU Legislation:

EMC directive 2004/108/EC

Based on the following harmonized standards:

EN55014-1:2000 EMC Emissions

EN55014-2:1997 EMC Immunity

And therefore complies with the essential requirements of those directives.

Additional information:

Technical file number: TF-753.133-000

Location of technical file: Munster Simms Engineering Ltd, 2 Enterprise Road, Belfast, BT19 7TA

Year mark first applied: 2015

Limitations of use: For use with Whale original 12V submersible pumps, filters and mains water hook up only.

Name and position of person binding the manufacturer or authorized representative:

Name: Richard Bovill

Function: Engineering Director

CE marked: 2015



External face of socket rated to IP45 when lid closed



This Whale product is covered by a 1 year warranty. Please see the enclosed document for details of our Statement of Limited Warranty.

© Copyright Whale 2018 - All rights reserved.

Reproduction in whole or in part without permission is prohibited. WHALE®, is a registered trademark of Munster Simms Engineering Limited, Bangor, Northern Ireland trading as Whale. Whale's policy is one of continuous improvement and we reserve the right to change specifications without prior notice. Illustrations are for guidance purposes only. Neither the accuracy nor completeness of the information contained in this or any product literature is guaranteed by the Company and may be subject to change at its sole discretion.

10. Water In Socket Mounting Profile

Please note that this diagram is for guidance purposes only and is **NOT** to scale. If you require specific advice about your installation please contact Whale Support.

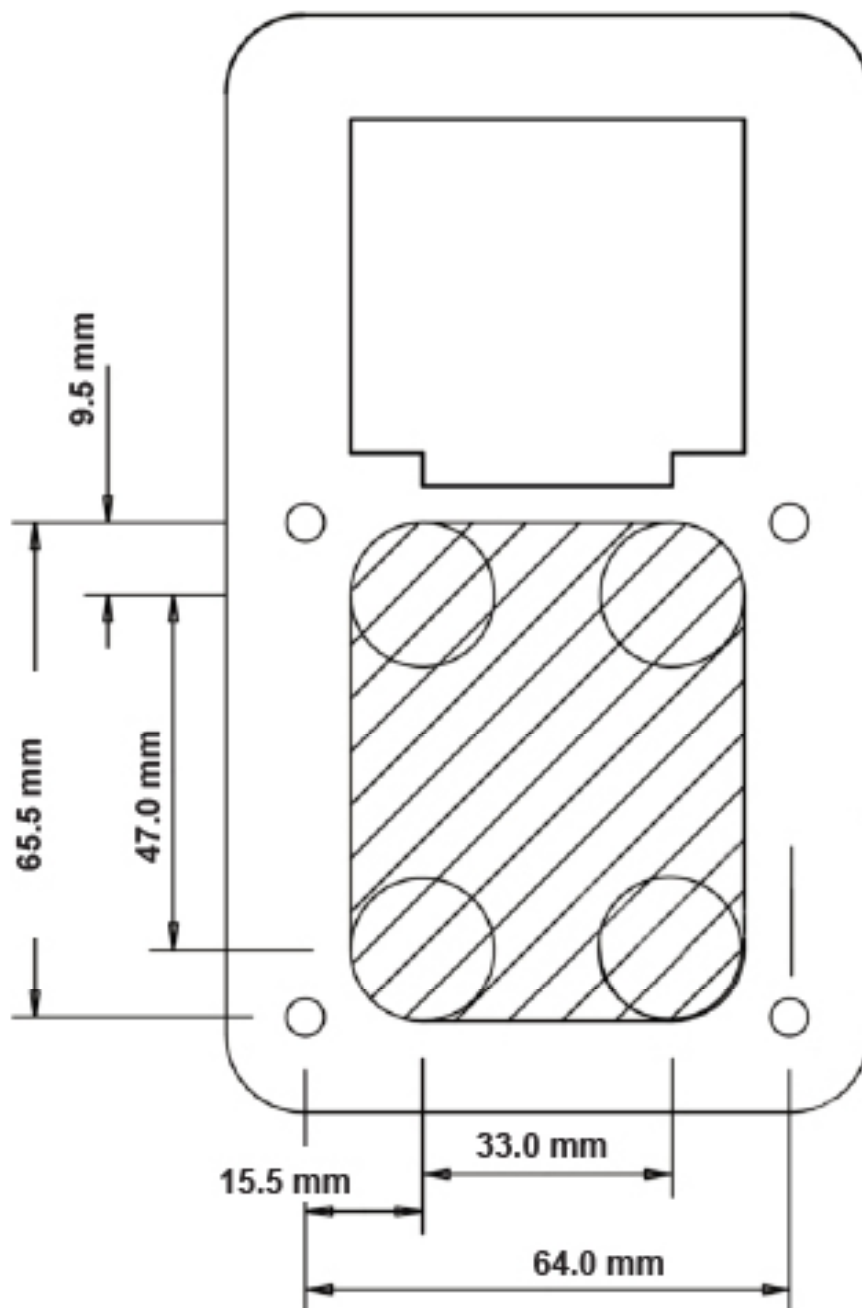



Munster Simms Engineering Ltd.
2 Enterprise Road, Bangor, N Ireland, BT19 7TA
Tel: +44 (0)28 9127 0531
+44 (0)845 217 2933
info@whalepumps.com

whalepumps.com

